

LAJ=20°09'03.241"S
LONG=53°17'23.415"W

LAJ=20°09'06.213"S
LONG=53°17'22.020"W

LAJ=20°09'09.124"S
LONG=53°17'20.654"W

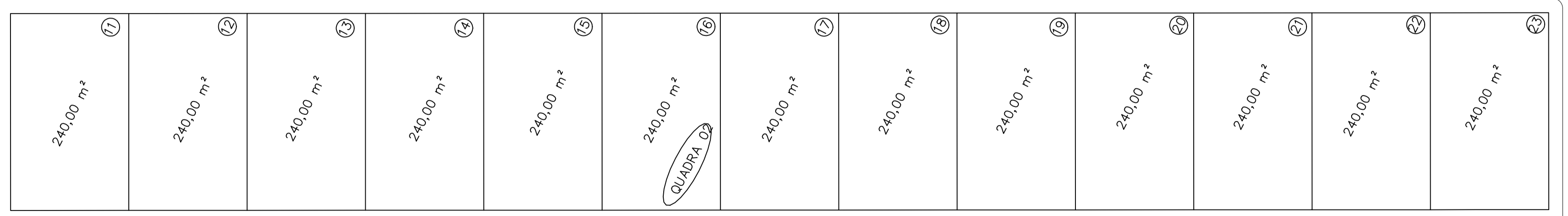
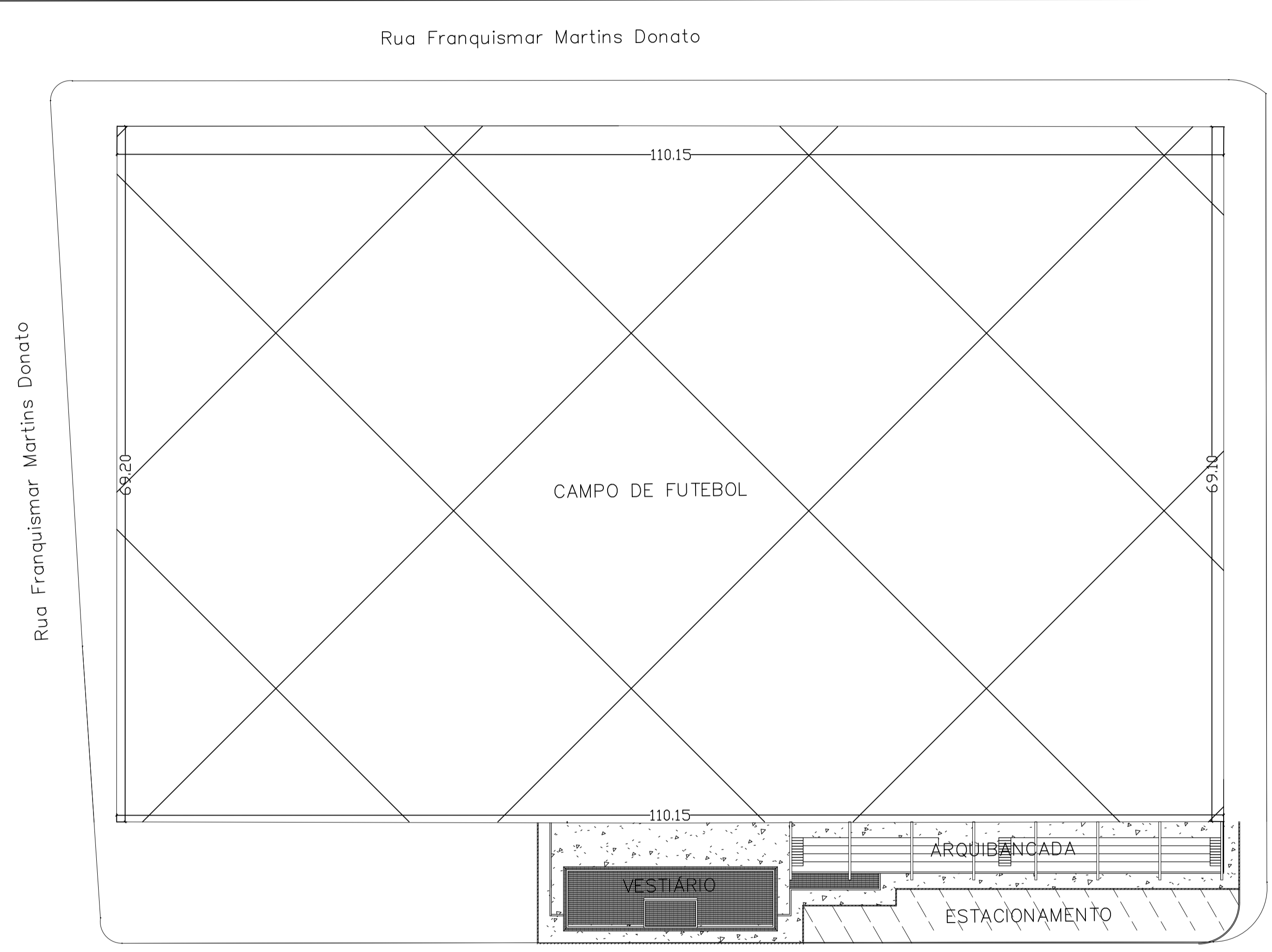
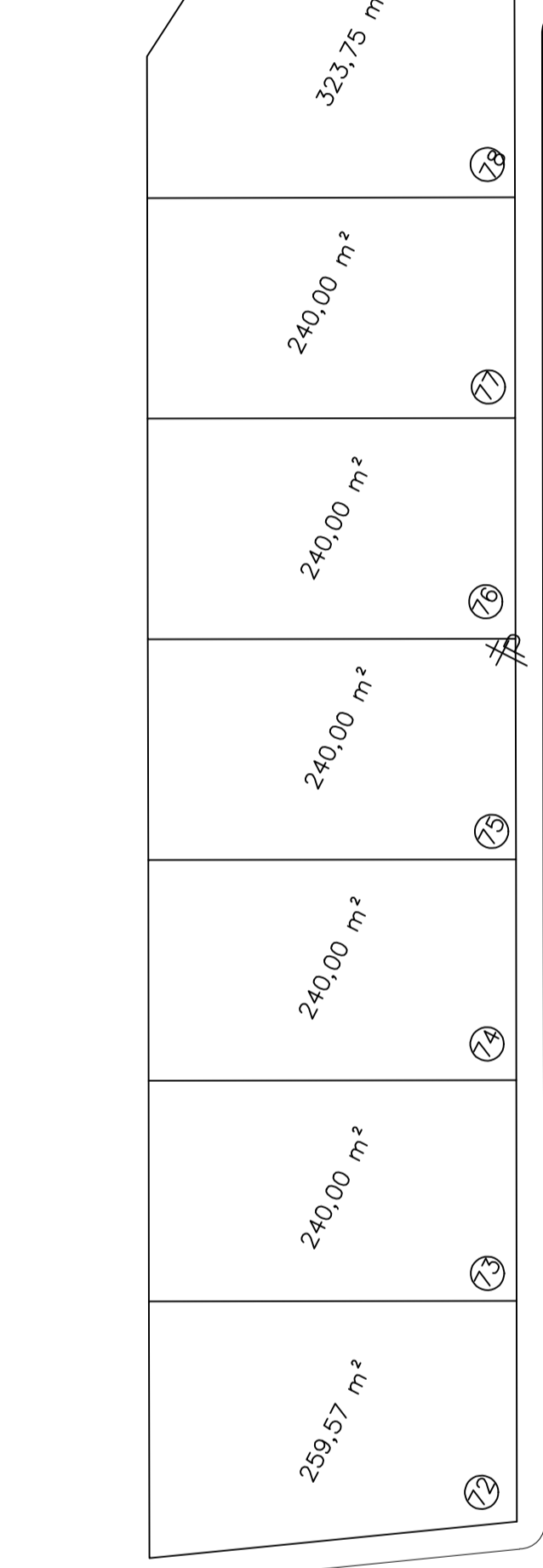
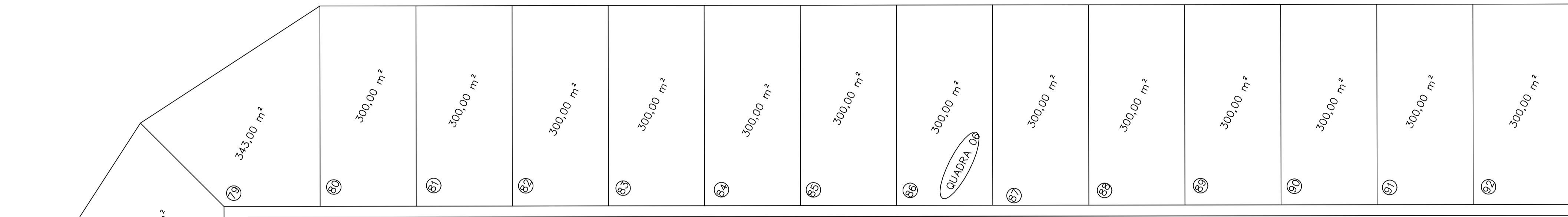

LAJ=20°09'05.492"S
LONG=53°17'28.930"W

LAJ=20°09'08.465"S
LONG=53°17'27.539"W

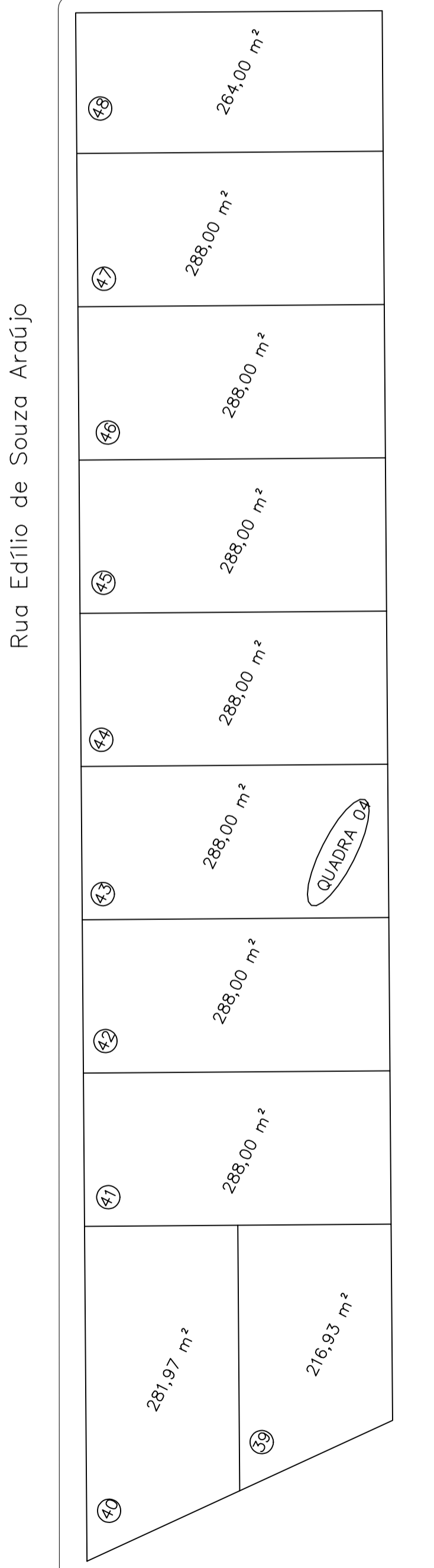

LAJ=20°09'11.365"S
LONG=53°17'26.182"W

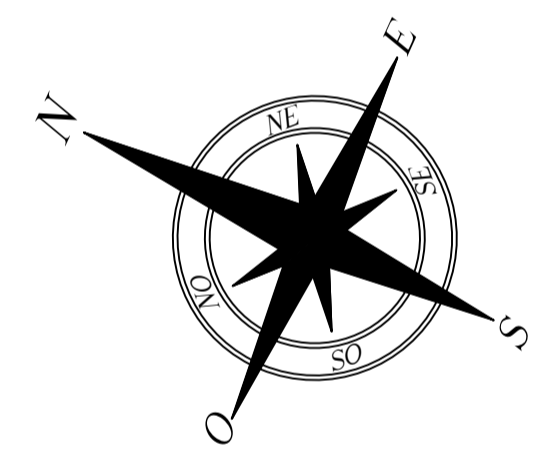

<p>DESCRIÇÃO</p> <p>PROJETO DO VESTIÁRIO E ARQUIBANCADA LADO ESQUERDO CAMPO URBADO TRISTÃO</p> <p>PLANTA DE LOCALIZAÇÃO</p>	
<p>PROPRIETÁRIO:</p> <p>PREFEITURA MUNICIPAL DE BREJETUBA</p>	
<p>LOGRADOURO:</p> <p>RUA ANTÔNIO LUIZ BADARÓ</p>	<p>CONTATO:</p> <p>ron7@ron7.com.br - 27-3733-1349 / 27-99970-7034</p>
<p>MUNICÍPIO:</p> <p>BREJETUBA</p>	<p>RESPONSÁVEL TÉCNICO:</p>
<p>ESTADO:</p> <p>ESPIRITO SANTO</p>	<p>Claudinei Uliana Roncete</p> <p>Engenheiro Civil</p> <p>CREA:ES-042472/D</p>
<p>USO:</p> <p>COMUNITÁRIO</p>	<p>CARTÓRIO CNS:</p> <p>02.141-0</p>
<p>DATA:</p> <p>DEZEMBRO/ 2017</p>	<p>MATRÍCULA:</p> <p>11996</p>
<p>PRANCHA:</p> <p>01/01</p>	<p>ESCALA:</p> <p>1:350</p>
<p>CONTEUDO DA PRANCHA:</p> <p>PLANTA DE LOCALIZAÇÃO</p>	

